

**COMBINATION LOCK -LM0825
MANUAL**

1.0 PRODUCT AND ACCESSORIES

1.1 Please check and ensure all the below product and accessories are inside the package (depend on order).
If any missing or damaged found, please contact to your dealer for replacement and corrective action.

1 Combination Lock Unit

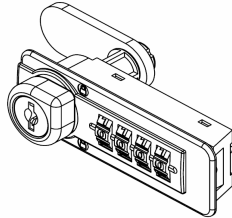

2 Plate clip

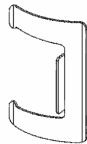

3 Override key

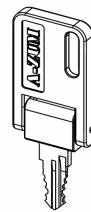

4 Back Cover (Metal)

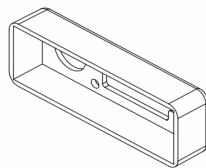

5 Back Cover (Wooden)

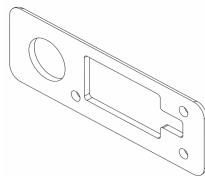

6 M3 screw



2.0 PART IDENTIFICATION

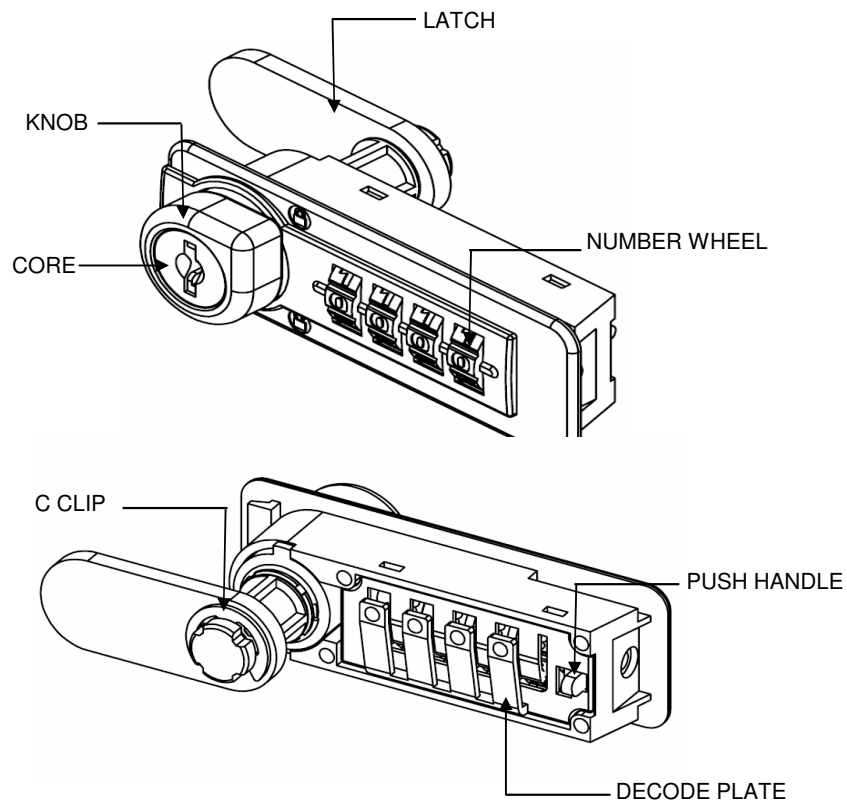

2.0 INSTALLATION

2.1 Prepare a hole follow the below diagram

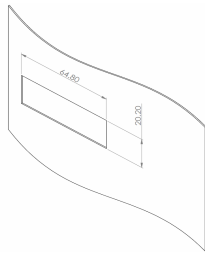

STEEL PLATE MOUNTING HOLE
64.8mm X 20.2 mm

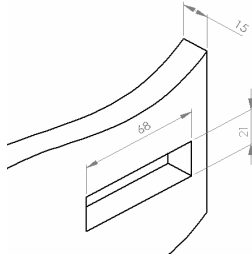

WOODEN MOUNTING HOLE
68mm X 21 mm

2.2 Installation using Plate clip

- Insert combination lock unit to the hole that prepared in 2.1
- Slide in the Plate clip into the slot.

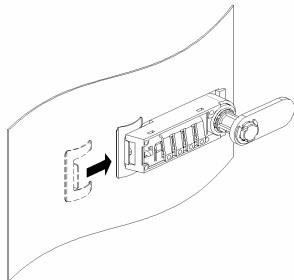

2.3 Installation using Back cover (Metal) or Back cover (Wooden)

- Remove the C-clip and Cam
- Install Combination Lock unit to the hole prepared in 2.1

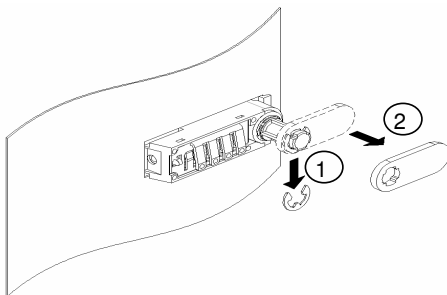

- Install the Back Cover and tighten the screw
- Reinstall the C-clip and the cam

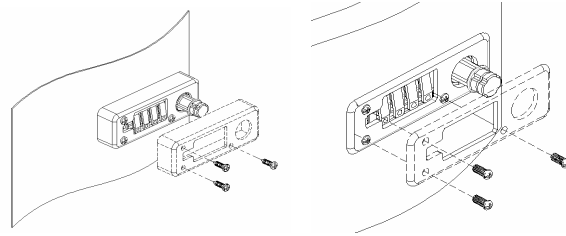

3.0 LOCK AND UNLOCK

3.1 To lock and unlock using Combination Code

- Enter the combination code by rotate the Number Wheel
- Turn the Knob according printed logo

3.2 To lock and unlock using Override key

- Override Key are using for unlock and lock in condition forgot the combination code
- If unlock using Override Key must lock using Override Key. Prohibited to unlock using Override Key then lock by enter combination code
- Insert the Override Key to the core slot and turn the key according printed logo

4.0 TO CHANGE COMBINATION CODE

- Enter the current combination code
- Position the Push handle as illustrate in below diagram

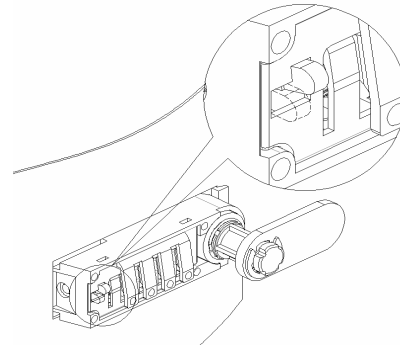

- Enter new code and position back the Push handle to original condition

5.0 TO DECODE THE COMBINATION CODE

- Push the Decode Plate finger (only 1 at time) at the back of combination lock unit
- Slightly turn down the Numbering Wheel until feel the step.
- Identified the number at the front and release the Decode Plate finger.
- To get the correct number for the combination code need to turn down the Numbering Wheel for next 3 number for left version and for right version turn up 3 number.

Example:

Left version

- IF identified no is 7 the exact code is 0
- IF identified no is 8 the exact code is 1

Right version

- IF identified no is 3 the exact code is 0
- IF identified no is 2 the exact code is 9

- Repeat this step for next 3 code numbers.