

LINK OPENING SYSTEM

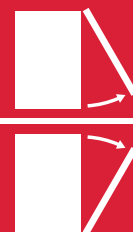

OPENING
SYSTEMS
FOR FLAP AND
DROP DOWN
DOORS

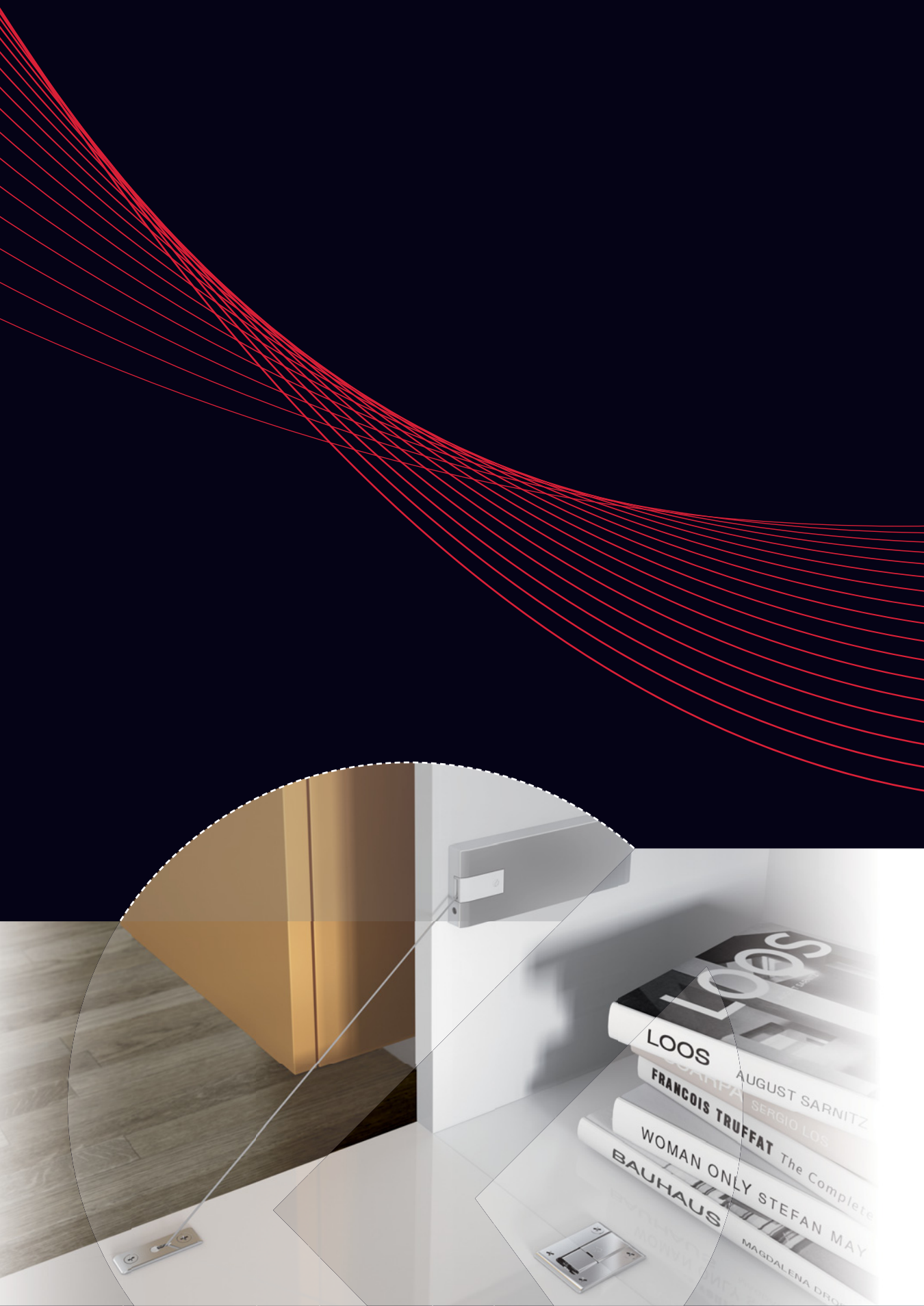



SYMBOLS AND FINISHES LEGEND

SYMBOLS

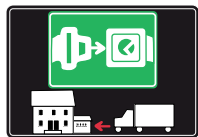

= SHELF SAFELY LOCKED DURING
TRANSPORTATION AND AT HOME



= ANTI-TURNOVER LOCKING
SYSTEM



= NORMS / PATENTS



= PHILLIPS / POZIDRIV



= NEWTON



= PART.NO



= HEXAGONAL SOCKET



= FRICTION



= PCS. PER PACKAGE



= BLADE SLOT



= AUTOMATIC



= COMBI SLOT



= DROP DOWN



= CAPACITY LOADING



= COUNTERSUNK HEAD



= WOOD / GLASS THICKNESS



= PAN HEAD



= STANDARD HINGE



= HOLE DIAMETER



= FLANGE HEAD



= KIMANA HINGE



= DIAMETER



= FLAT HEAD



= FLAP HINGE



= LENGTH



= TRILOBULAR SCREW



= WITH SPRING



= HEIGHT



= SELF-TAPPING SCREW



= WITHOUT SPRING



= RIGHT VERSION



= EURO THREAD



= REVERSED SPRING



= LEFT VERSION



= METRIC THREAD



= SETTING CODE



= PRE-INSERTED SCREW



= FOR ROUND TUBE



= PCS. PER PAD



= PRE-INSERTED SCREW
AND SPREADING BUSH



= FOR OVAL TUBE



= CUT ON REQUEST



= WITH BUFFER



= SELF ADHESIVE



= WITH MAGNET



= WITH FLANGE

MATERIALS

ZA = Zinc Alloy	ST = Steel	HSS = High Speed Steel	BR = Brass	ABS = Acrylonitrile Butadiene Styrene
ZAnk = Nickel-plated Zinc Alloy	STzk = Zinc-plated Steel	AL = Aluminium	WD = Wood	EVA = Ethylene Vinyl Acetate

EP = **ENGINEERING PLASTIC**

+ **EP** = other engineering plastic available on request

SR = **SOFT RUBBER**

+ **SR** = other soft rubber available on request

EPn = Natural Engineering Plastic

EPc = Clear Engineering Plastic

SRn = Natural Soft Rubber

EPw = White Engineering Plastic

EPg = Grey Engineering Plastic

SRw = White Soft Rubber

EPwg = Water Green Engineering Plastic

SRb = Black Soft Rubber



FINISHES



+ = OTHER FINISHES AVAILABLE ON REQUEST

PART. NO	FINISHES	PART. NO	FINISHES	PART. NO	FINISHES
AA	Natural	JB	Bright Aluminium	QA	Maple
AB	White	JC	Aluminium - Chrome	QB	Walnut
AC	Opal White	JD	Matt Aluminium	UZ	T -Met
AE	White 9010	JE	Satin-finished Aluminium	WA	Bronzed
AK	Champagne	JF	Aluminium - Brass	WI	Burnished
AL	Ivory	JG	Aluminium 5	XD	Satin-finished Steel
EA	Black	JL	Aluminium PE 11	YA	Nickel-plated
EB	Glossy Black	JM	Aluminium RAL 9006	YB	Bright Nickel-plated
EC	Matt Black	KA	Chrome	YC	Matt Nickel-plated
FU	Gunmetal	KB	Bright Chrome	YD	Satin-finished Nickel-plated
GR	Raw	KC	Matt Chrome	ZA	Zinc alloy
HA	Brass-Plated	MA	Brown	ZN	Zinc-plated
HH	Tropicalized	MB	Light Brown 1	ZQ	Bright Gold
HL	Raw Brass	NN	Metallic Beige	ZY	Titanium
IA	Grey	NO	Beige	ZZ	Clear
IB	Metallic Grey	OA	Oak	00	Insignificant finish
IF	Middle Grey	OZ	Ash		
IJ	Light Grey	PA	Light Ash		
IL	Grey 20	PZ	Beech		

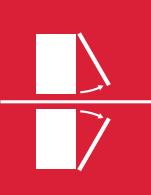

OPENING
SYSTEMS FOR
FLAP AND
DROP DOWN
DOORS

LINK

 **ITALIANA**
ferramenta



LINK



PATENTED

The freshly-designed drop-down opening system conceived by Italiana Ferramenta.

Unhanded mechanism for cabinet sides, the only one on the market that guarantees both a soft opening and a smooth closing movement of the door.

Installation is carried out through very simple drilling operations that don't require neither mills nor grooves.

A complete range suits all the doors weights and dimensions.

Suitable for very shallow cabinets with a minimum depth of 200 mm.

Very simple installation, once the mechanism is fixed on the side, the metal wire end is pulled out and the small sphere inserted onto the narrow slot of the door bracket. The sphere catches onto the bayonet cavity and is permanently secured in position with the provided cover cap.

Open angle adjustment carried out by using a S3 allen wrench, for nearby doors alignment.

The zinc alloy nickel plated mechanism cover, as well as the door bracket, can be supplied painted on request.

All the parts are in steel, zinc alloy and engineering plastic.



INSTALLATION

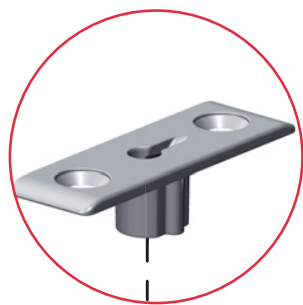

The door bracket has to be placed with the narrow part of the drop-shaped slot facing the cabinet.

Recommended fixing countersunk head wood screws $\varnothing 4 \times 18$ mm for door 18 mm min. thick.

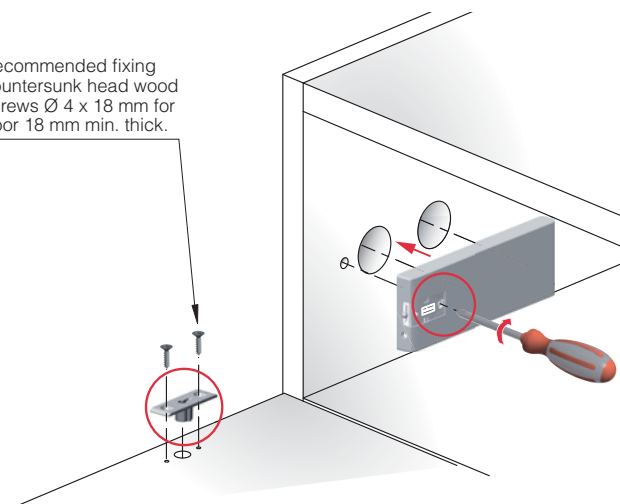

Pre-inserted screw $\varnothing 3,5 \times 16$ mm - PZ2.

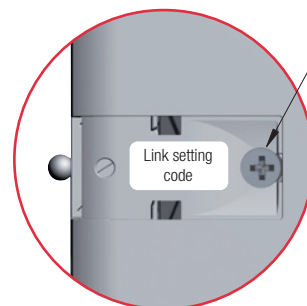

UNHANDED MECHANISM

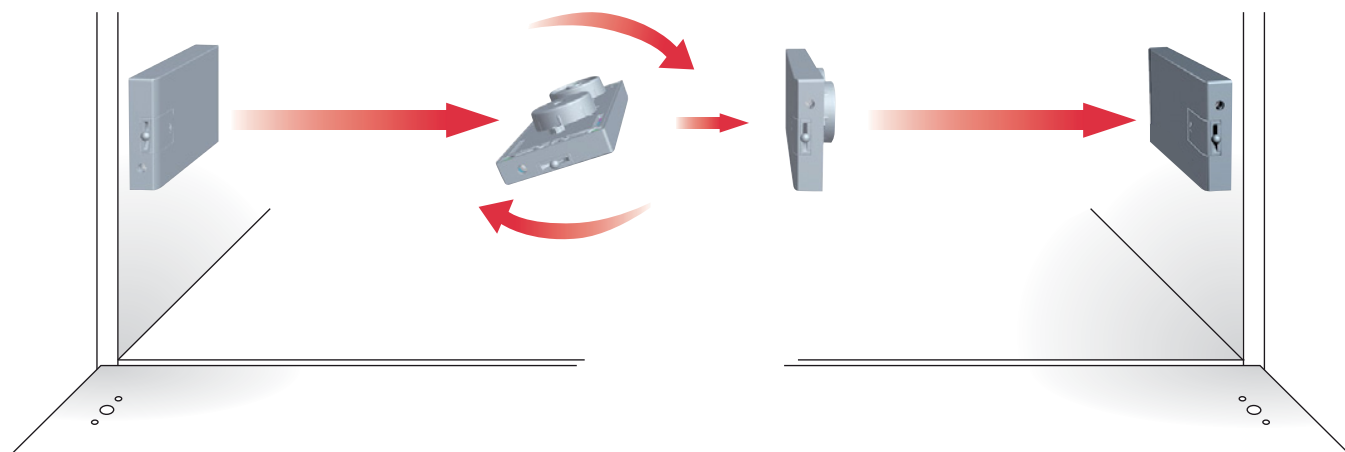

COVER CAP INSERTION

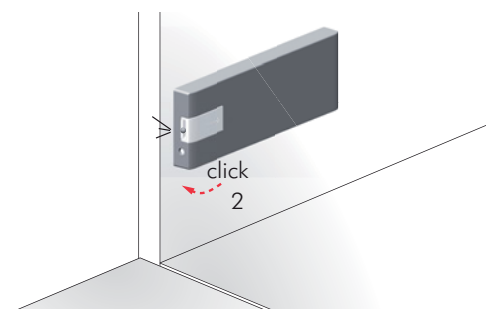
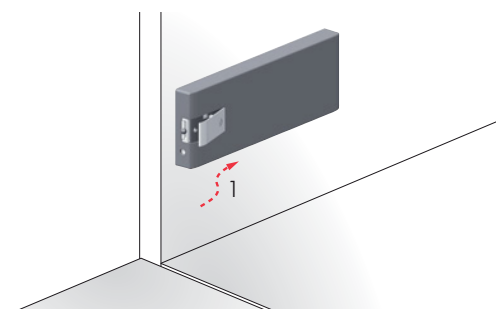

METAL WIRE INSERTION ONTO THE DOOR BRACKET

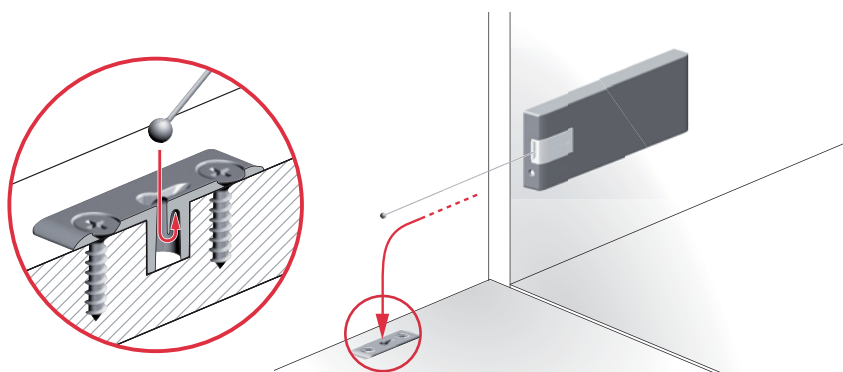

PLASTIC WIRE LOCKING

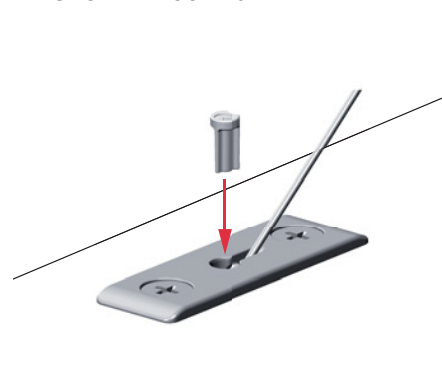



ADJUSTMENT

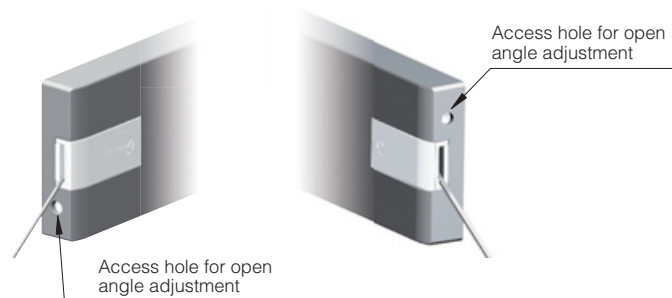
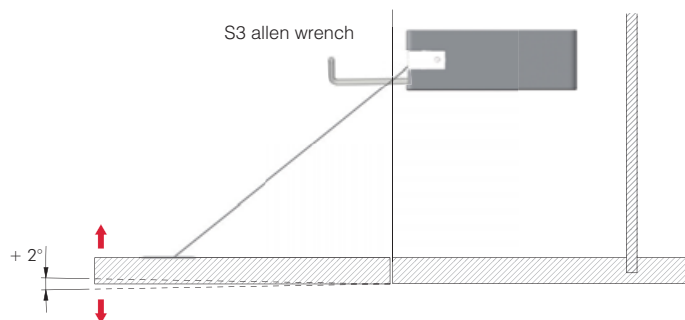

SOFT OPENING

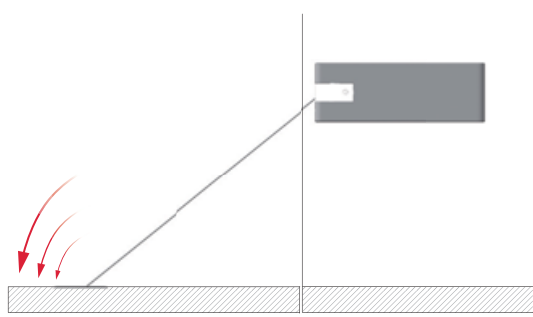

SMOOTH CLOSING

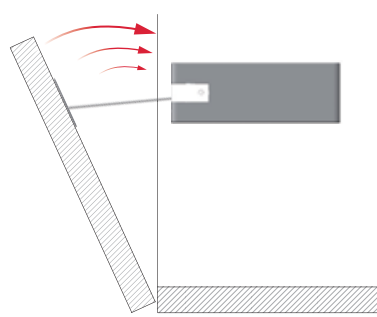

Soft opening and smooth closing are guaranteed only when opening and closing cycles are fully carried out.

LINK REMOVAL

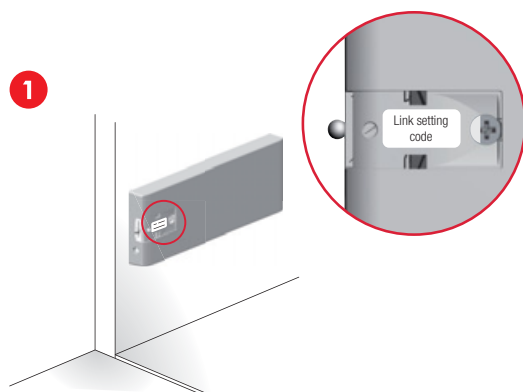

Turn S3 allen wrench clockwise till its travelling end for access to the locking screw.

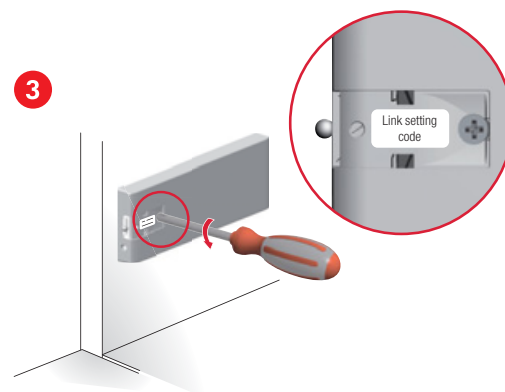
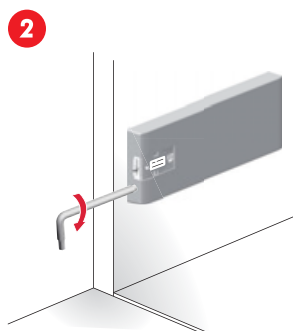

LINK SETTINGS IDENTIFICATION

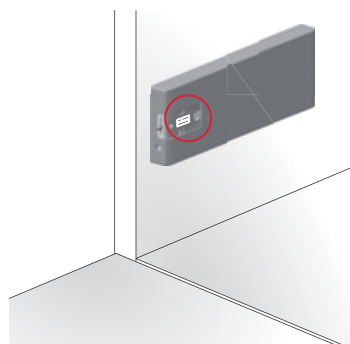
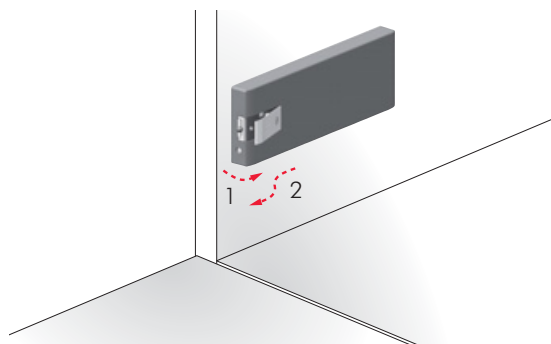

Label to identify the LINK setting code.

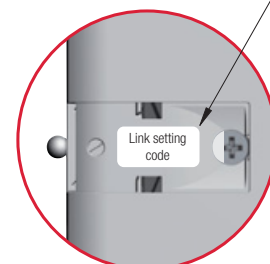

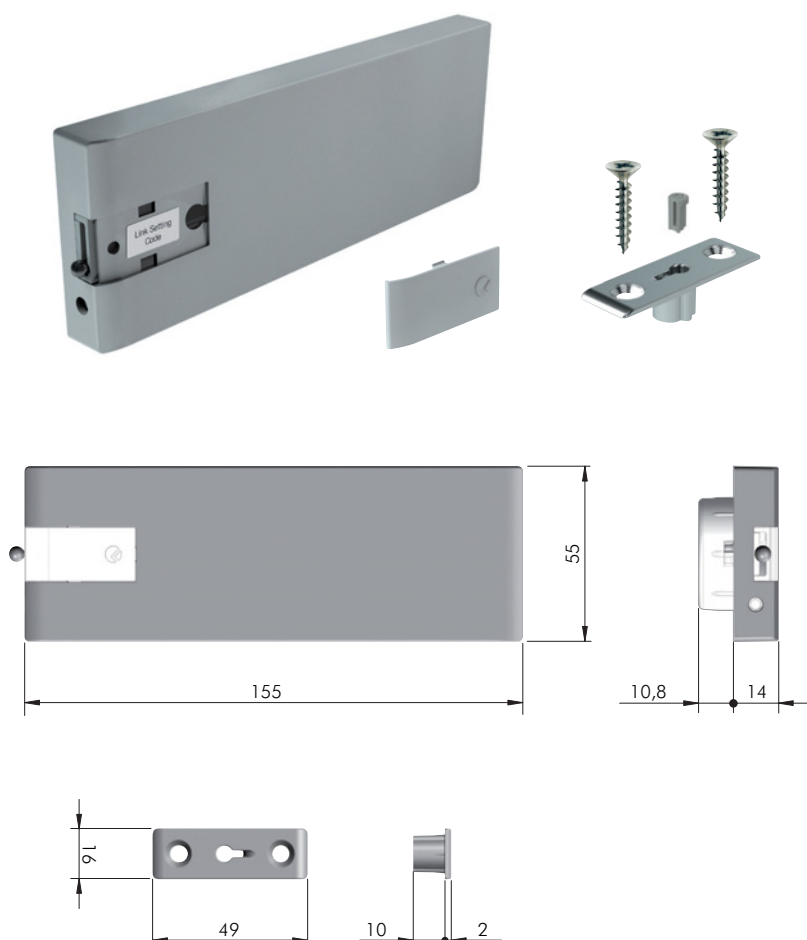

<div> <div>ZA</div> <div>EP</div> <div>ST</div> <div> = 12 pcs. </div> </div>				
47005020UZ	AE	JL	FU	A262
47010020UZ	AE	JL	FU	E262
47015020UZ	AE	JL	FU	F262
47020020UZ	AE	JL	FU	N262
47025020UZ	AE	JL	FU	O262
47030020UZ	AE	JL	FU	U262
47032020UZ	AE	JL	FU	X262
47035020UZ	AE	JL	FU	AL280
47038020UZ	AE	JL	FU	AQ300
47040020UZ	AE	JL	FU	AQ335

NOTE: LINK is supplied in carton box including 1 piece, door bracket nickel-plated, countersunk fixing screws Ø 4 x 18 mm nickel-plated, cover cap and fitting guide.

OPTIONAL DOOR BRACKETS

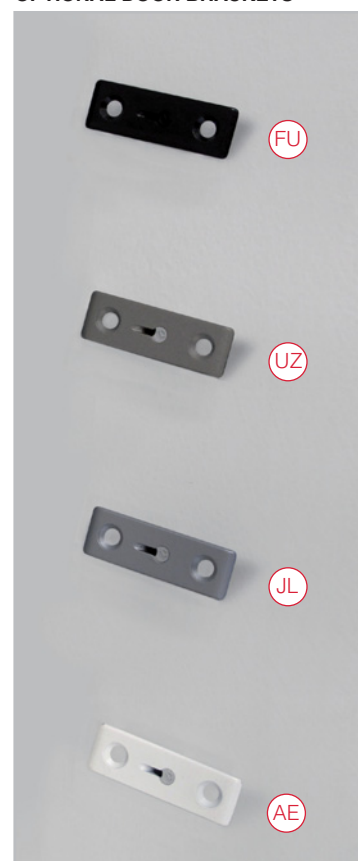
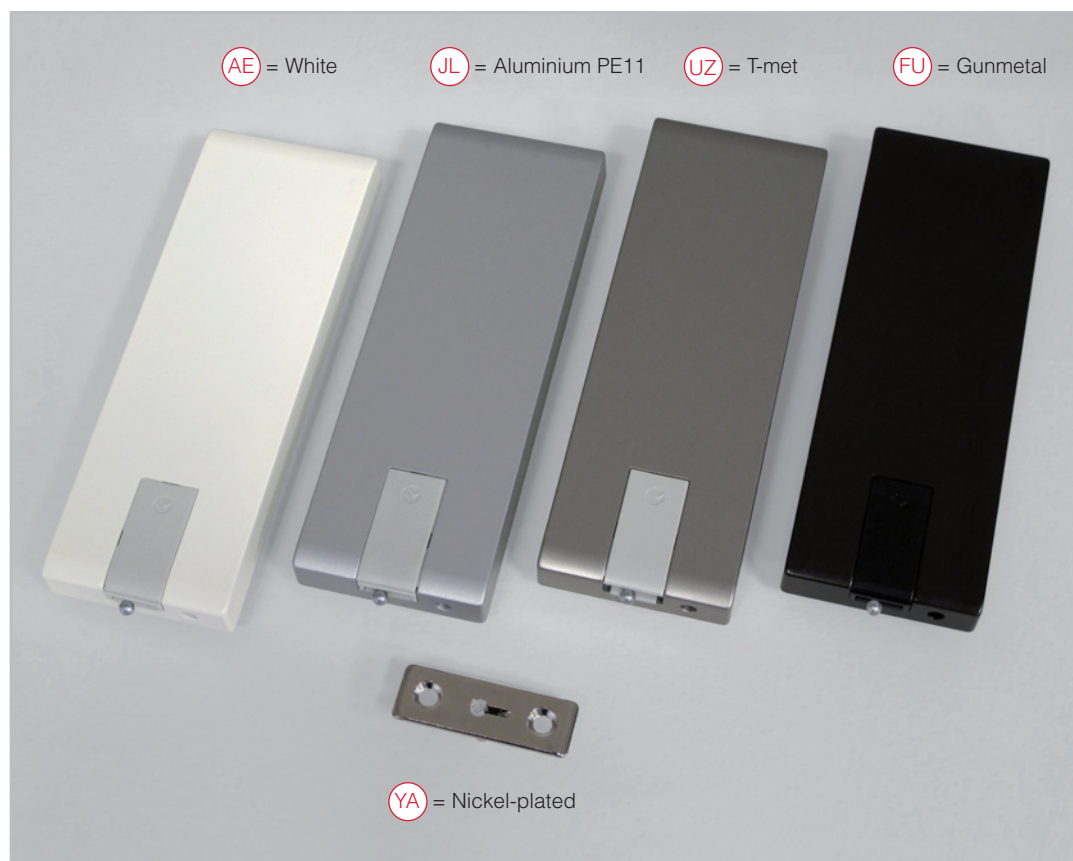



ZA ST



Available on request



ZA ST



Available on request



ZA ST



Available on request



ZA ST



Available on request

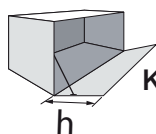

Kg = Door weight including the possible handle.

Rev. 00

h	A262		E262		F262		N262		O262		U262		X262		AL280		AQ300		AQ335	
	Kg	Link	Kg	Link	Kg	Link	Kg	Link	Kg	Link	Kg	Link	Kg	Link	Kg	Link	Kg	Link	Kg	Link
250	2,0 - 2,9	x 2	2,9 - 3,8	x 2	3,8 - 4,2	x 2	4,2 - 4,7	x 2	4,7 - 5,6	x 2	5,6 - 6,0	x 2	6,0 - 7,3	x 2	7,3 - 8,6	x 2	8,6 - 11	x 2	11 - 12,3	x 2
	1,0 - 1,4	x 1	1,4 - 1,8	x 1	1,8 - 2,0	x 1	2,0 - 2,4	x 1	2,4 - 2,7	x 1	2,7 - 3,0	x 1	3,0 - 3,6	x 1	3,6 - 4,9	x 1	4,9 - 6,5	x 1	6,5 - 7,0	x 1
300	2,0 - 2,8	x 2	2,8 - 3,3	x 2	3,3 - 3,7	x 2	3,7 - 4,1	x 2	4,1 - 5,0	x 2	5,0 - 5,5	x 2	5,5 - 6,4	x 2	6,4 - 7,3	x 2	7,3 - 9,8	x 2	9,8 - 10,9	x 2
	1,0 - 1,2	x 1	1,2 - 1,5	x 1	1,5 - 1,8	x 1	1,8 - 2,0	x 1	2,0 - 2,3	x 1	2,3 - 2,6	x 1	2,6 - 3,2	x 1	3,2 - 4,1	x 1	4,1 - 5,1	x 1	5,1 - 5,5	x 1
350	1,7 - 2,1	x 2	2,1 - 2,4	x 2	2,4 - 2,9	x 2	2,9 - 3,7	x 2	3,7 - 4,1	x 2	4,1 - 4,7	x 2	4,7 - 5,6	x 2	5,6 - 6,5	x 2	6,5 - 8,7	x 2	8,7 - 9,9	x 2
	-	-	-	-	1,1 - 1,3	x 1	1,3 - 1,6	x 1	1,6 - 1,8	x 1	1,8 - 2,0	x 1	2,0 - 2,7	x 1	2,7 - 3,5	x 1	3,5 - 4,6	x 1	4,6 - 5,0	x 1
400	1,5 - 1,9	x 2	1,9 - 2,2	x 2	2,2 - 2,6	x 2	2,6 - 3,1	x 2	3,1 - 3,5	x 2	3,5 - 4,0	x 2	4,0 - 4,8	x 2	4,8 - 5,8	x 2	5,8 - 7,7	x 2	7,7 - 8,9	x 2
	-	-	-	-	-	-	1,0 - 1,5	x 1	1,5 - 1,7	x 1	1,7 - 1,9	x 1	2,0 - 2,4	x 1	2,4 - 2,9	x 1	2,9 - 4,1	x 1	4,1 - 4,6	x 1
450	-	-	-	-	2,0 - 2,5	x 2	2,5 - 2,9	x 2	2,9 - 3,2	x 2	3,2 - 3,8	x 2	3,8 - 4,2	x 2	4,2 - 5,1	x 2	5,1 - 7,1	x 2	7,1 - 7,8	x 2
	-	-	-	-	-	-	-	-	1,0 - 1,2	x 1	1,2 - 1,5	x 1	1,5 - 2,0	x 1	2,0 - 2,7	x 1	2,7 - 3,6	x 1	3,6 - 4,0	x 1
480	-	-	-	-	-	-	2,0 - 2,5	x 2	2,5 - 2,8	x 2	2,8 - 3,0	x 2	3,0 - 3,3	x 2	3,3 - 4,8	x 2	4,8 - 6,7	x 2	6,7 - 7,2	x 2
	-	-	-	-	-	-	-	-	-	x 1	1,1 - 1,4	-	1,4 - 2,0	x 1	2,0 - 2,5	x 1	2,5 - 3,3	x 1	3,3 - 3,7	x 1

These are experimental results to be checked by the customer.

In accordance with the actual laws, we suggest to use 2 LINK mechanisms for each door. In case the door weight/dimensions are bigger than those reported on the charts, 3 or more LINK mechanisms might be used. Please contact the authorized dealer.

LINK WITH KIMANA HINGE

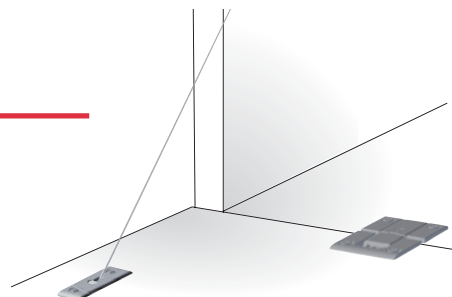
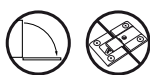

DOOR PANEL DRILLING PLAN

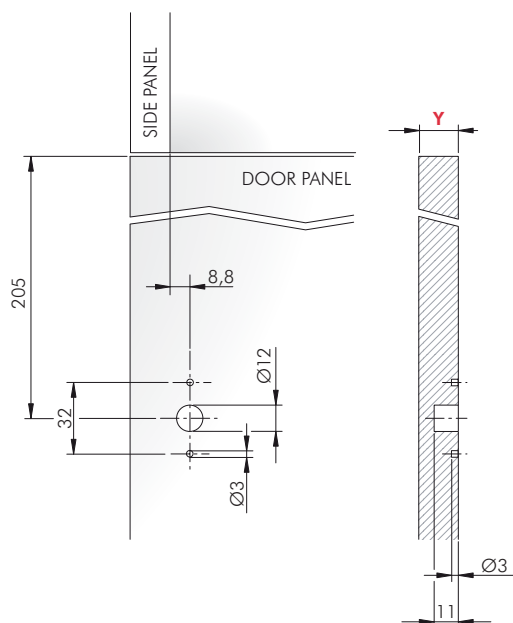

SIDE PANEL DRILLING PLAN

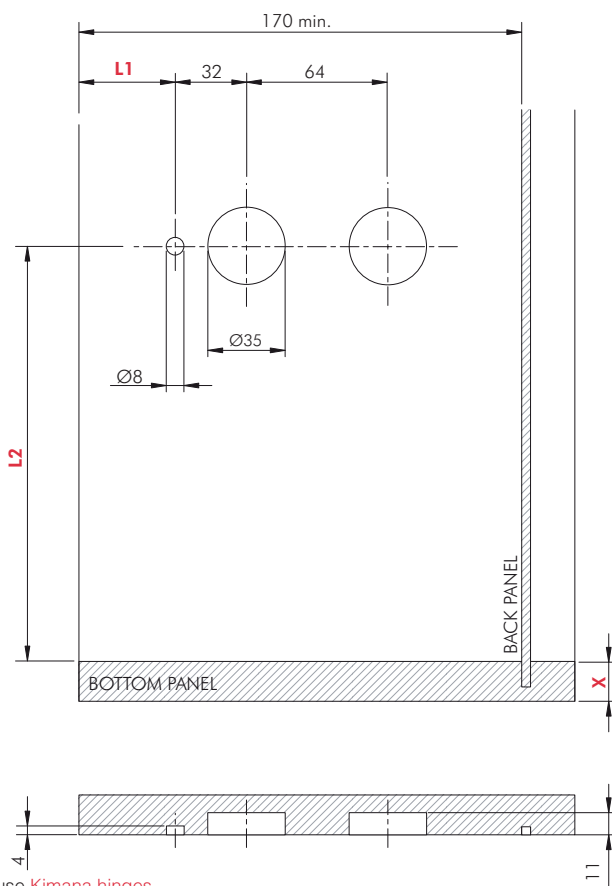

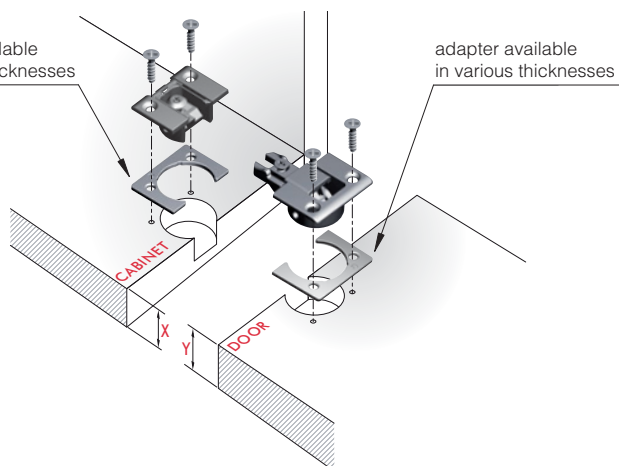

The dimensions of the above drilling plan refer to carcasses which use Kimana hinges.

adapter available
in various thicknesses



adapter available
in various thicknesses

X + 	Y + 	L1	L2
16 + 4	16 + 2	43	187,5
16 + 4	19	44	187,5
18 + 2	18	43	185
18 + 2	19	44	185
19	16 + 2	42	185
19	19	43	185
20	20	43	185

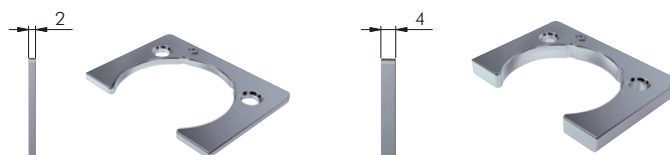

For Kimana and adapter details refer to section "HINGES".



LINK WITH FLAP HINGES

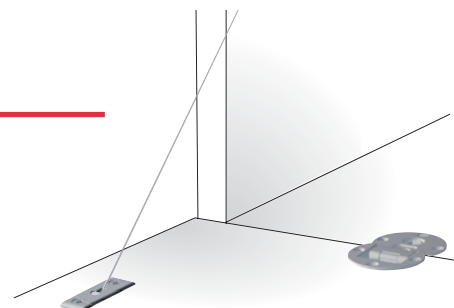
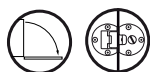

DOOR PANEL DRILLING PLAN

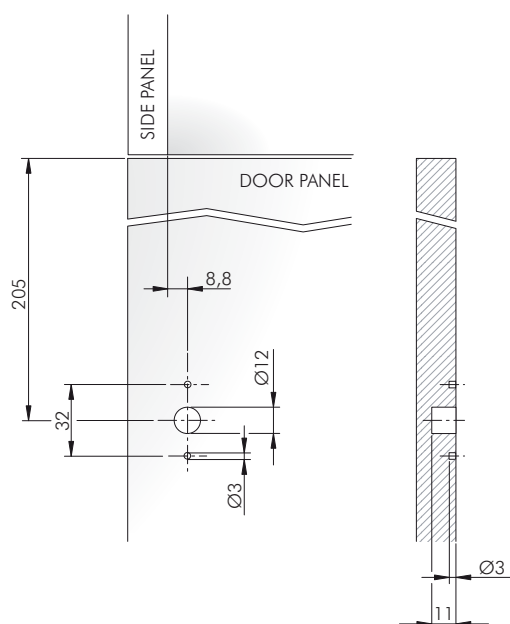

SIDE PANEL DRILLING PLAN

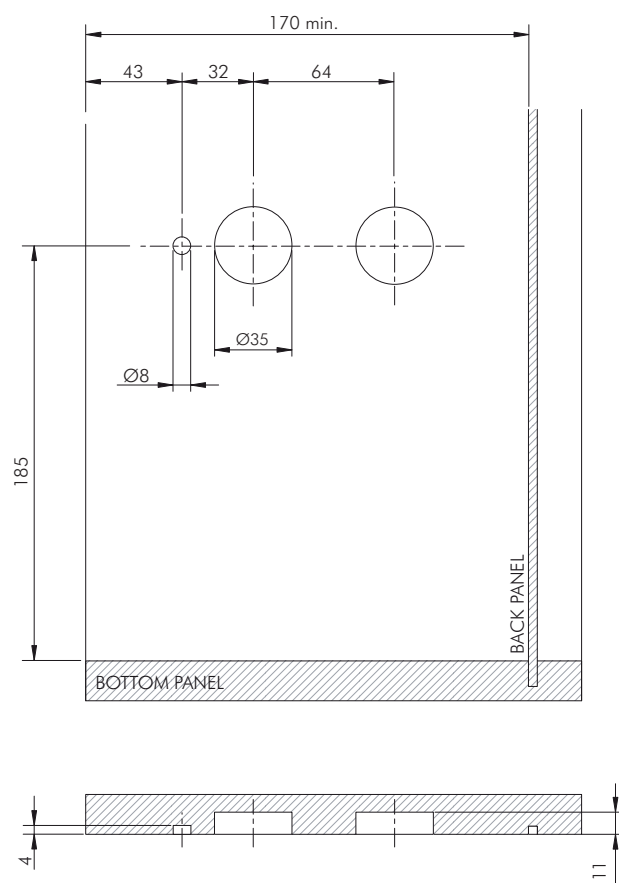

The dimensions of the drilling plan refer to carcasses which use flap hinges.

LINK WITH STANDARD UNSPRUNG HINGES



In case other hinges than KIMANA are used, it is necessary to contact an authorized dealer for a correct drilling scheme.
For this purpose, use the form at the end of the LINK section to provide the required specifications.

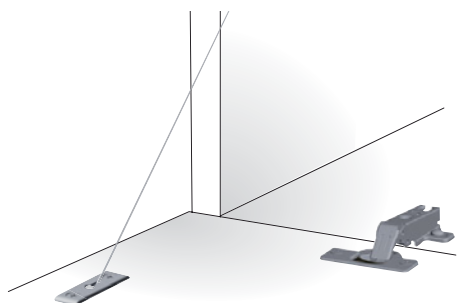



CUSTOMER: Company name

REFERENCE: Mr. John Smith

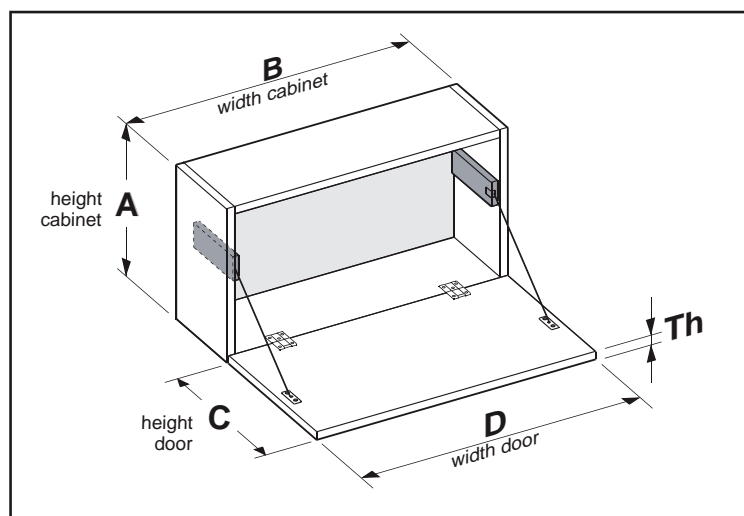
**IMPORTANT NOTES**

TO IDENTIFY THE APPROPRIATED MECHANISM "LINK" IT IS NECESSARY FOR US TO GATHER THE FOLLOWING INFORMATIONS:

- DOOR DIMENSIONS
- DOOR WEIGHT WITH HANDLE(*)
- TYPE OF HINGES

(*) If you don't have the actual weight of the door, it is possible to estimate the weight by considering the density of the material.

Common materials:

- CHIPBOARD door 650 Kg/m³ (average value).
- MDF door 780 Kg/m³ (average value).

KIND OF HINGES

☐ **KIMANA hinges**
(Recommend)



☐ **FLAP hinges**



☒ **STANDARD UNSPRUNG hinges**
Brand, model, mounting plate

Please specify producer, article code mounting plate

☐ **Other hinges**

Please specify producer, article code mounting plate

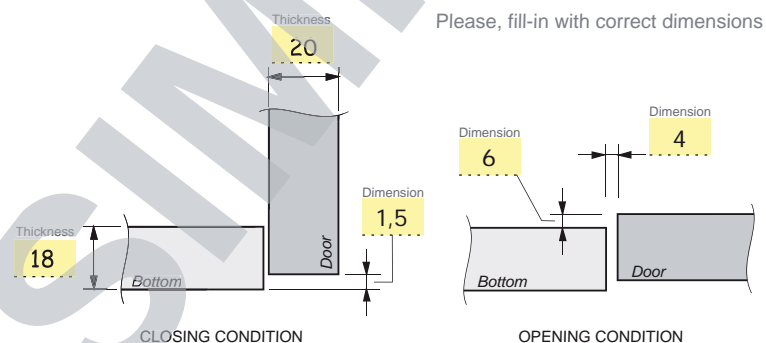
**INNER SHELVES**

The positioning of inner shelves (either fixed or removable) can lead to the modification of the standard drilling plan.

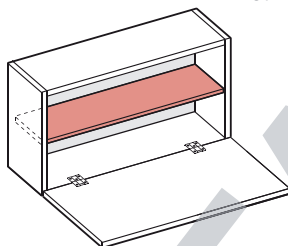

☐ **YES**

It's necessary to send us the exact positioning on a drawing

☒ **NO**

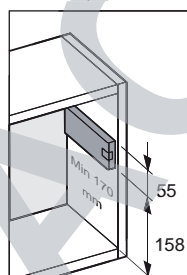

Standard position mechanism LINK

PARTITIONS

Inner partitions can be used to add another opening mechanism (for particularly heavy doors).

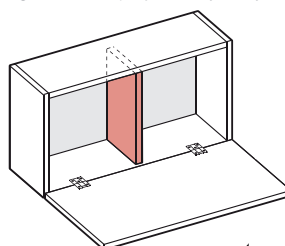

☐ **YES**

It's necessary to send us the exact positioning and thickness on a drawing

☒ **NO**

K PUSH

In order to determine the right LINK settings, it's useful to know about the presence of K-PUSH.

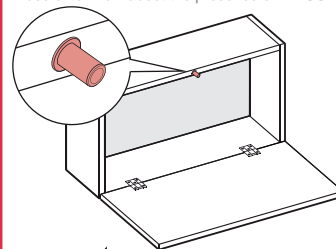

☒ **YES**

☐ **NO**

ID	Description	Cabinet		Door specifications					
		A Height mm	B Width mm	C Height mm	D Width mm	Th mm	Weight Kg	Actual	Estimated
1	Wall cabinet	360	1000	357	997	20	5,2	X	
2									
3									
4									
5									

LINK FINISH			
GREY PE11	WHITE RAL 9010	T - MET.	GUNMETAL
X			



CUSTOMER:

REFERENCE:

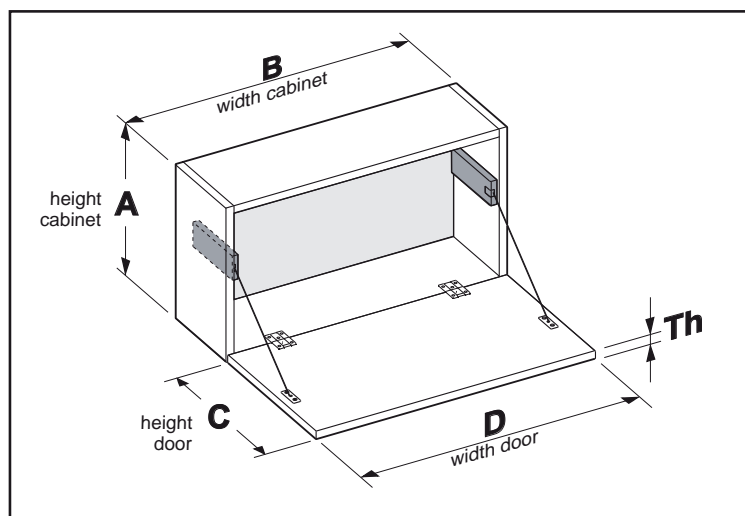

IMPORTANT NOTES

TO IDENTIFY THE APPROPRIATED MECHANISM "LINK" IT IS NECESSARY FOR US TO GATHER THE FOLLOWING INFORMATIONS:

- DOOR DIMENSIONS
- DOOR WEIGHT WITH HANDLE(*)
- TYPE OF HINGES

(*) If you don't have the actual weight of the door, it is possible to estimate the weight by considering the density of the material.

Common materials:

- CHIPBOARD door 650 Kg/m³ (average value).
- MDF door 780 Kg/m³ (average value).

KIND OF HINGES



☐ **KIMANA hinges**
(Recommend)



☐ **FLAP hinges**



☐ **STANDARD UNSPRUNG hinges**

Please specify producer, article code mounting plate

☐ **Other hinges**

Please specify producer, article code mounting plate

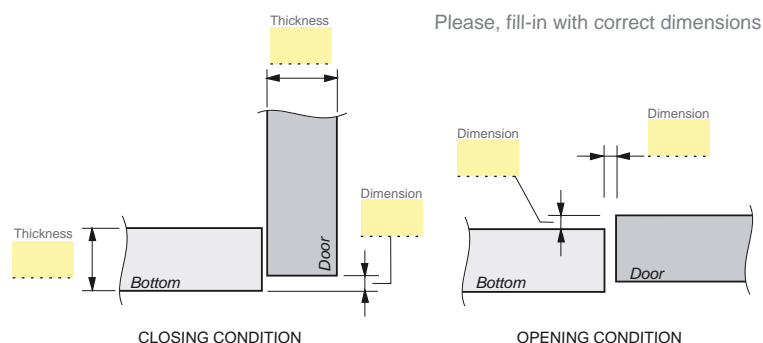

Please, fill-in with correct dimensions

CLOSING CONDITION

OPENING CONDITION

INNER SHELVES

The positioning of inner shelves (either fixed or removable) can lead to the modification of the standard drilling plan.

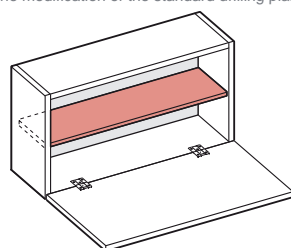

☐ **YES**

It's necessary to send us the exact positioning on a drawing

☐ **NO**

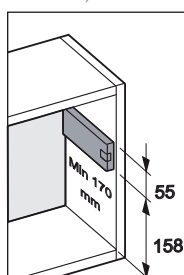

Standard position mechanism LINK

PARTITIONS

Inner partitions can be used to add another opening mechanism (for particularly heavy doors).

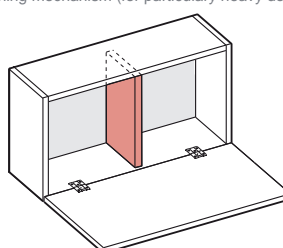

☐ **YES**

It's necessary to send us the exact positioning and thickness on a drawing

☐ **NO**

K PUSH

In order to determine the right LINK settings, it's useful to know about the presence of K-PUSH.

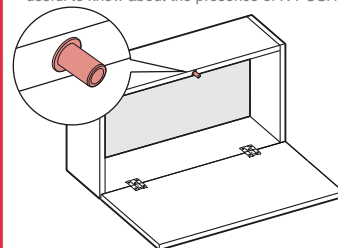

☐ **YES**

☐ **NO**

		Cabinet		Door specifications						LINK FINISH			
ID	Description	A Height mm	B Width mm	C Height mm	D Width mm	Th mm	Weight Kg	Actual	Estimated	GREY PE11	WHITE RAL 9010	T-MET.	GUNMETAL
1													
2													
3													
4													
5													

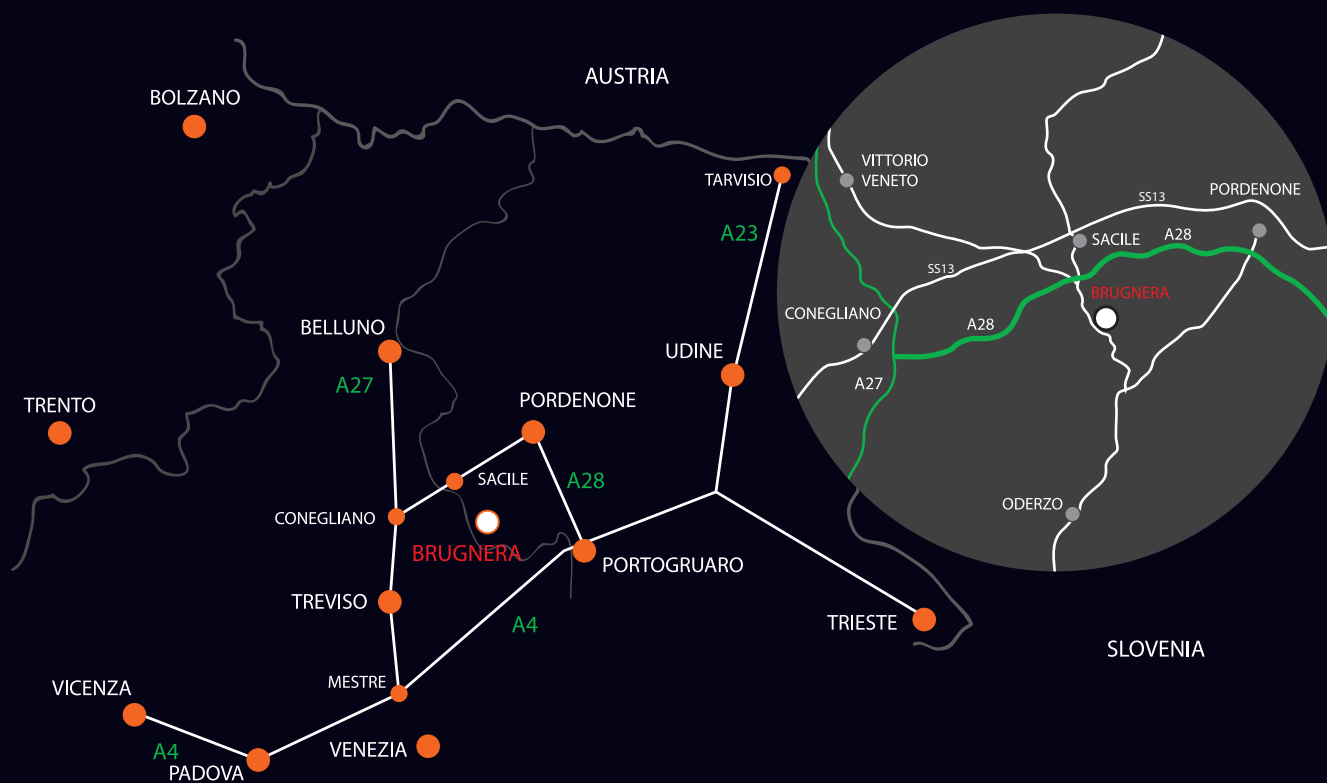

www.italianaferramenta.com